

MICRO SWITCHES

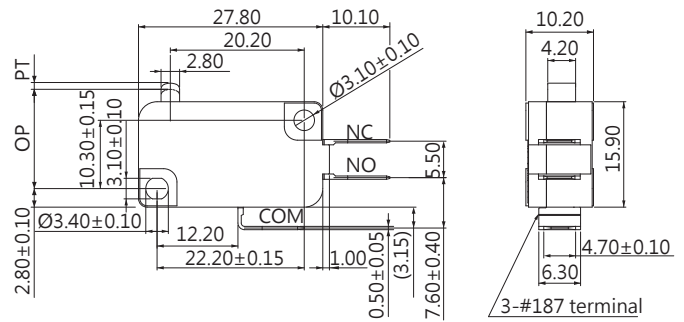

DIMENSIONS

Unless otherwise specified, a tolerance of $\pm 0.4\text{mm}$ applies to all dimensions.



VA1 SERIES

SPECIFICATIONS

Contact Resistance(initial)

Max. 300 m Ω

Measured by ohm meter - open voltage < 1VDC, driver current - 100 mA

Insulation Resistance (at 500 VDC / minute)

Min. 100 M Ω

Dielectric Strength

Min. 500VAC(50-60HZ)/minute between Live parts.

Min. 1500VAC(50-60HZ)/minute between Live parts and dead metal parts

Operating Temperature Range

-40°C to 125°C (with no icing)

Vibration

10~55Hz, displacement 0.75 mm (p-p)

Electrical Service Life

0.1A - Min. 1,000,000 operations

others Rating - Min. 10,000 operations

Electrical Operating Frequency

10~30 operations per minute

Mechanical Service Life

Min. 10,000,000 operations

Mechanical Operating Frequency

120 operations per minute

Operating application of the switch

Set the switch pushing distance from 60% to 90% of the specified OT value

MOUNTING HOLES

2- $\varnothing 3.1$ mounting holes
or M3 screw holes

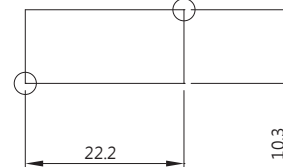

CERTIFICATE INFORMATION

Model Name	UL, cUL	ENEC
VA1-P1	0.1RA 125/250VAC μ T85 5E4	0.1A 125/250VAC, μ 40T125 1E4
VA1-03	3RA 125/250VAC μ T85 5E4	3A 125/250VAC, μ 40T125 1E4
VA1-06	6RA 125/250VAC μ T85 5E4	6.1(2.5)A 125/250VAC, μ 40T125 1E4
VA1-10	10RA 125/250VAC μ T85 5E4	10(4)A 125/250VAC, μ 40T125 1E4
VA1-16	16RA 125/250VAC μ T85 5E4	16(4)A 125/250VAC, μ 40T125 1E4
VA1-20H	20RA 125/250VAC μ T85 2E4	20(4)A 125/250VAC, μ 40T125 1E4
VA1-26Q	Non	26A 125/250VAC, μ T85 1E4

APPLICATIONS

Joystick, TV Game, Time Recorder, Air Conditioner, Food Processor, Juice Maker, Alarm, Mixer, Shredder Machine, Power Tool

CONTACT CONFIGURATION

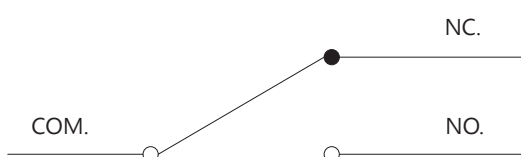

THE SELECTION OF RATING & FORCE

MODEL	Rating	D	J	L	S	H	Q
VA1	0.1A	*	*	*	*	*	
	3A	*	*	*	*	*	
	6A 6.1(2.5)A	*	*	*	*	*	
	10A 10(4)A		*	*	*	*	
	16A 16(4)A		*	*	*	*	
	20A					*	
	26A						*

NOTE : The Symbol " * " to represent the result is accepted

TERMINAL TYPES

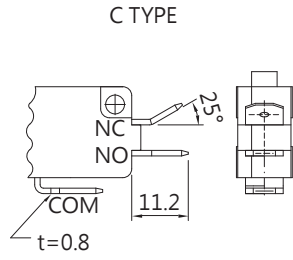

3-#250 terminal

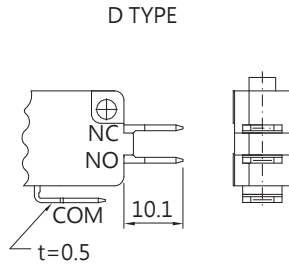

3-#187 terminal

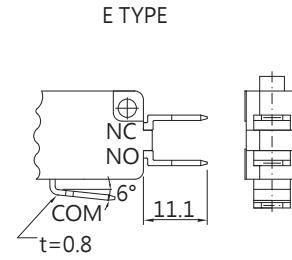

3-#250 terminal

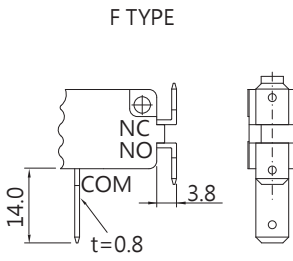

3-#250 terminal

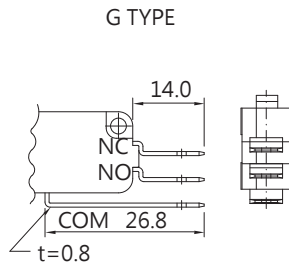

3-#250 terminal

ORDERING INFORMATION

V	A	1	-	0	6	H	0	-	0	1	D	0	-	Z
SERIES PREFIX	CODE	RATING CURRENT	CODE	OPERATING FORCE	CODE	ACTUATOR LEVER FIXED	CODE	ACTUATOR TYPE	CODE	TERMINAL TYPE	CODE	CIRCUIT ARRANGEMENT	ROHS CODE	
	P1	0.1A 125/250VAC	Q	HEAVIER	0		00		C	250 SERIES (C)	0	S.P.D.T		
	03	3A 125/250VAC	H	HEAVY	1		01		D	187 SERIES (D)	1	S.P.S.T. NO		
	06	6A 125/250VAC	S	STANDARD	2		02		E	250 SERIES (E)	2	S.P.S.T. NC		
	10	10A 125/250VAC	L	LIGHT			03		F	250 SERIES (F)				
		10(4)A 125/250VAC	J	SLIGHT			04		G	250 SERIES (G)				
	16	16.1A 125/250VAC	D	LIGHTNESS			05							
		16(4)A 125/250VAC					06							
	20	20A 125/250VAC												
		20(4)A 125/250VAC												
	26	26A 125/250VAC												

#NOTE

	RATING CURRENT	OPERATING FORCE
1	Code:P1	H,S,L,J,D
	Code:03	H,S,L,J,D
	Code:06	H,S,L,J,D
	Code:10	H,S,L,J
	Code:16	H,S,L,J
	Code:20	H
	Code:26	Q

OPERATING CHARACTERISTICS

SWITCH TYPE	PART SUFFIX	OF Max. (gf)						OP (mm)	PT Max. (mm)	OT Min. (mm)	MD Max. (mm)
		D	J	L	S	H	Q				
VA1- □□□ 0-00D0-Z		50	100	150	200	300	350	14.7±0.5	1.9	1.0	0.4
VA1- □□□ 1-01D0-Z		60	110	150	190	290	340	15.3±0.5	2.8	1.0	0.5
VA1- □□□ 2-01D0-Z		40	60	90	120	160	190	15.3±1.1	5.2	0.6	0.9
VA1- □□□ 1-02D0-Z		35	55	90	110	160	185	15.3±1.1	5.9	1.2	1.0
VA1- □□□ 2-02D0-Z		20	35	50	65	95	110	15.3±2.1	9.7	3.4	2.2
VA1- □□□ 1-03D0-Z		20	35	50	65	95	110	15.3±2.4	9.3	-	2.1
VA1- □□□ 2-03D0-Z		15	25	35	40	60	75	15.3±4.1	16.2	-	3.5
VA1- □□□ 1-04D0-Z		35	65	90	120	175	205	18.7±1.3	5.5	1.9	1.1
VA1- □□□ 2-04D0-Z		20	40	55	70	100	120	18.7±2.0	8.7	3.2	1.7
VA1- □□□ 1-05D0-Z		60	110	223	220	310	375	20.7±0.6	2.7	1.1	0.45
VA1- □□□ 2-05D0-Z		35	65	95	120	180	210	20.7±1.0	4.65	0.8	0.8
VA1- □□□ 1-06D0-Z		30	60	120	125	165	200	20.45±1.6	3.8	1.6	1.25
VA1- □□□ 2-06D0-Z		20	35	55	65	100	115	20.45±2.1	9.3	3.3	1.8

* There is another series of VA1 with MD reduced to 63%.