

PUSH SWITCHES



P8 SERIES

SPECIFICATIONS

Contact Resistance (initial)

Max. 50mΩ

Measured by ohm meter –open voltage<1VDC, driver current -100mA

Insulation Resistance (at 500VDC/minute)

Min. 100MΩ

Dielectric Strength

Min. 1,000VAC(50-60HZ)/minute between Live parts.

Min. 3,000VAC(50-60HZ)/minute between Live parts and dead metal parts

Operating Temperature Range

-40°C to 85°C (with no icing)

Vibration

10~55HZ, displacement 0.75 mm (p-p)

Electrical Service Life

Min. 10,000 operations

Electrical Operating Frequency

10~30 operations per minute

APPLICATIONS

Juice Maker, Blender, Food processor

DIMENSIONS

Unless otherwise specified, a tolerance of ±0.4mm applies to all dimensions.

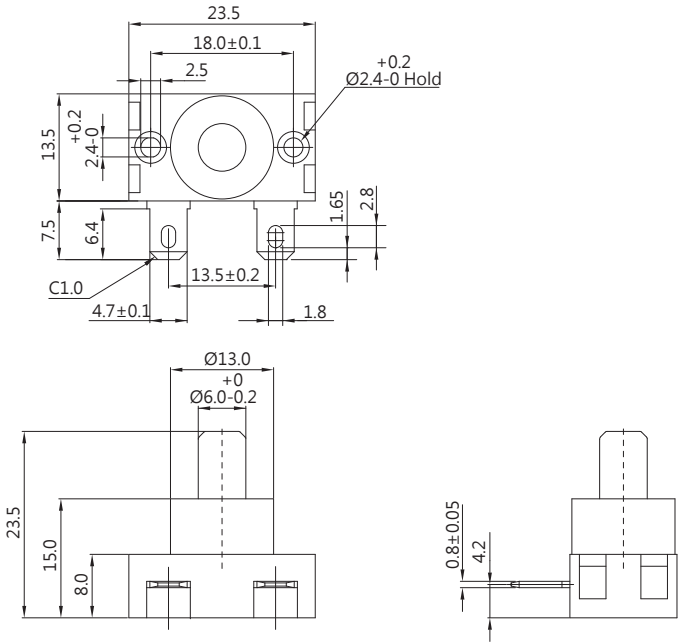

CONTACT CONFIGURATION

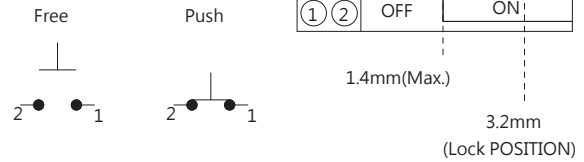

CERTIFICATE INFORMATION

Model Name	UL, cUL	ENEC
P8-10S	6A 250VAC 10A 125VAC (Temp85°C) Min. 6,000 operations	7(4)A 250VAC, μT85/551E4

TERMINAL TYPES

D TYPE

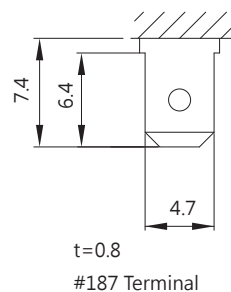

A TYPE

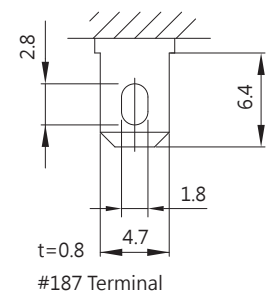

ORDERING INFORMATION

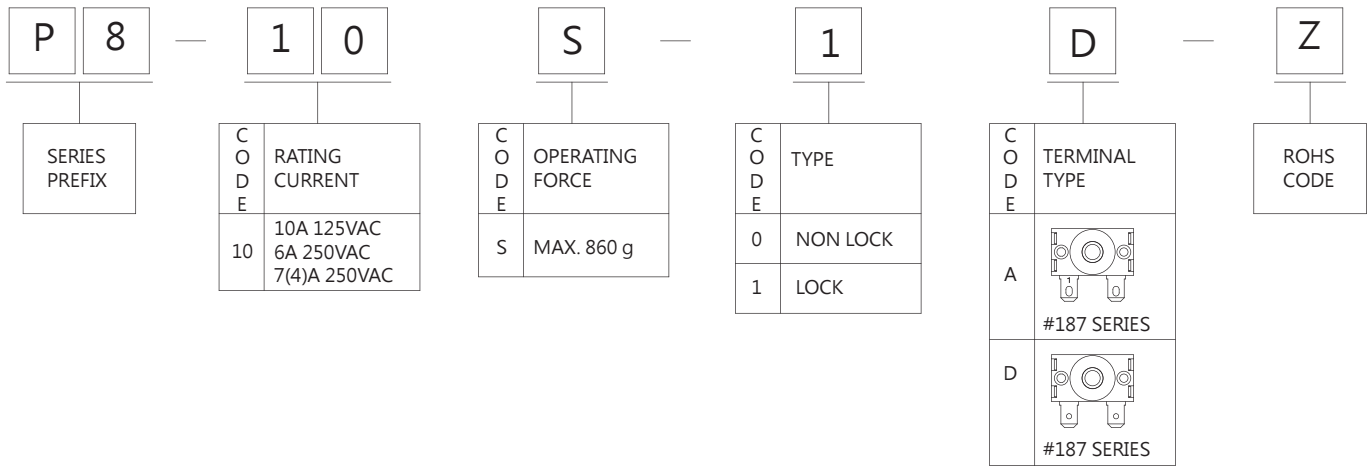

OPERATING CHARACTERISTICS

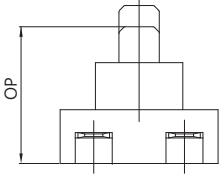
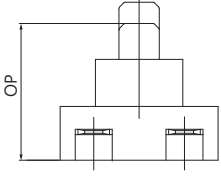
SWITCH TYPE	PART SUFFIX	OF Max (gf)	FULL TRAVEL (mm)	LOCK TRAVEL (mm)
P8-10S-0 □ -Z		860gf	4.0±0.5mm	---
P8-10S-1 □ -Z		860gf	4.0±0.5mm	2.0±0.5mm