

WATER PROOF SWITCHES

DIMENSIONS

Unless otherwise specified, a tolerance of $\pm 0.4\text{mm}$ applies to all dimensions.

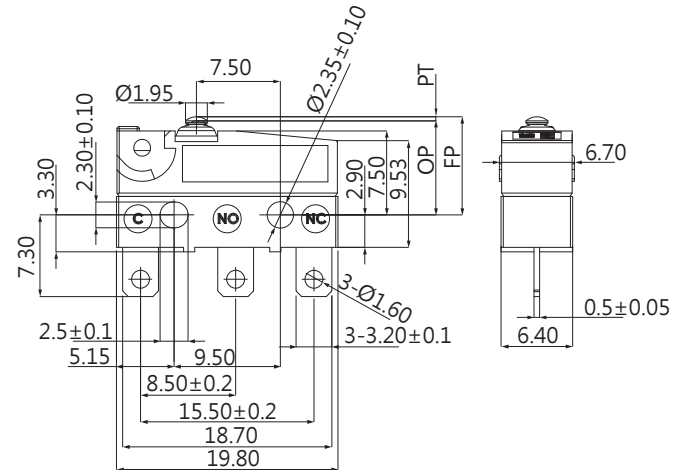

SW1 SERIES

SPECIFICATIONS

Contact Resistance (initial)

Max. 300m Ω

Measured by ohm meter - open voltage < 1VDC, driver current -100 mA

Insulation Resistance (at 500VDC/minute)

Min. 100M Ω

Dielectric Strength

Min. 500VAC(50-60HZ)/minute between Live parts.

Min. 1500VAC(50-60HZ)/minute between Live parts and dead metal parts

Operating Temperature Range

-40°C to 125°C (with no icing)

Vibration

10~55Hz, displacement 0.75 mm (p-p)

Electrical Service Life

Min. 10,000 operations

Electrical Operating Frequency

10~30 operations per minute

Mechanical Service Life

Min. 2,000,000 operations (D, L, S force Only)

Mechanical Operating Frequency

120 operations per minute

Operating application of the switch

Set the switch pushing distance from 60% to 90% of the specified OT value

MOUNTING HOLES

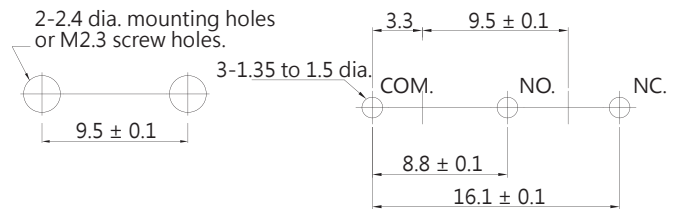

CERTIFICATE INFORMATION

Model Name	UL · cUL	ENEC
SW1-P1	0.1RA 30VDC μ T125 1E4 0.1RA 125/250VAC μ T125 1E4	0.1A 30VDC μ T125 1E4 0.1A 125/250VAC μ T125 1E4
SW1-06	5RA 30VDC μ T125 1E4 6RA 125/250VAC μ T125 1E4	5A 30VDC μ T125 1E4 6A 125/250VAC μ T125 1E4
SW1-10	5RA 30VDC μ T125 1E4 10RA 125/250VAC μ T125 1E4	5A 30VDC μ T125 1E4 10A 125/250VAC μ T125 1E4
SW1-12	5RA 30VDC μ T125 1E4 12RA 12GPA 125/250VAC μ T125 1E4	5A 30VDC μ T125 1E4 12A 125/250VAC μ T125 1E4

APPLICATIONS

Telephone, Air conditioner, Computer, Humidifier, Alarm, Time recorder, Mixer & Chopper, Solder gun, Neon phone, Fax machine, Joystick, Water pump, Gas detector, Pencil sharpener, Money sorter, Food processor, Electric knife, Toy car, Juice maker, Electric steak pan.

CONTACT CONFIGURATION

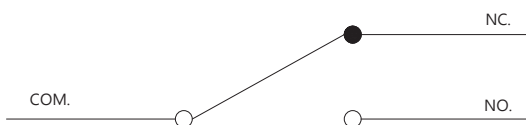

THE SELECTION OF RATING & FORCE

MODEL	Rating	D	L	S	H
SW1	0.1A	*	*	*	*
	6 A			*	*
	10A			*	*
	12A				*

NOTE : The Symbol " * " to represent the result is accepted

TERMINAL TYPES (The thickness of terminal is 0.5)

A TYPE

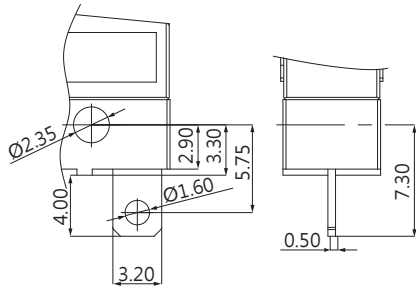

B TYPE

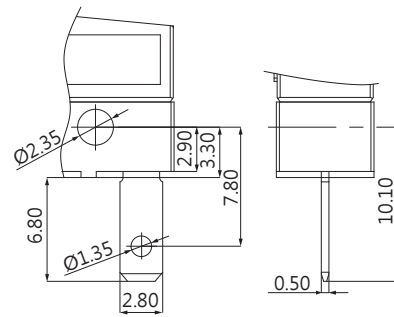

C TYPE

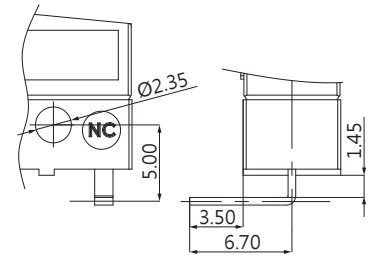

D TYPE

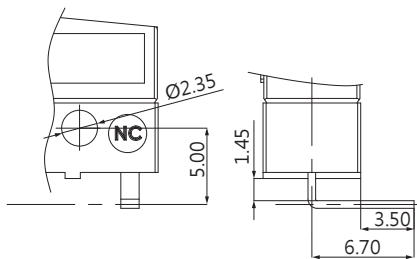



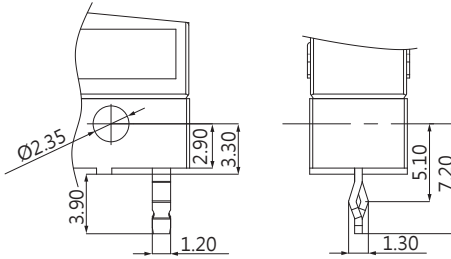



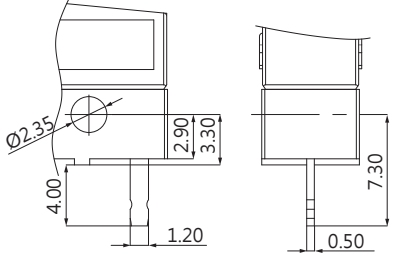

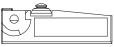

F TYPE



P TYPE

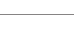

ORDERING INFORMATION

S	W	1	-	P	1	S	1	-	0	0	A	0	-	Z		
SERIES PREFIX	C O D E	RATING CURRENT		C O D E	O P E R T I N G F O R C E		C O D E	C O V E R T Y P E		C O D E	A C T U A T O R T Y P E	C O D E	T E R M I N A L T Y P E	C O D E	C I R C U I T A R R A N G E M E N T	R O H S C O D E
	P1	0.1A 125/250 VAC		H	HEAVIER		1			00		A		0	S.P.D.T	
	06	6A 125/250 VAC		S	STANDARD					01		B		1	S.P.S.T NO	
	10	10A 125/250 VAC		L	LIGHT					02		C		2	S.P.S.T NC	
	12	12A 125/250 VAC		D	SLIGHT					03		D				
												P				
												F				

#NOTE		
ITEM	RATING CURRENT	OPERATION FORCE
1	Code:P1	All
2	Code:06	H,S
3	Code:10	H,S
4	Code:12	H

OPERATING CHARACTERISTICS

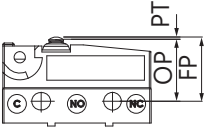
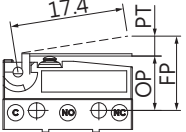
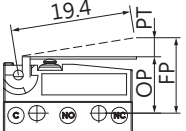
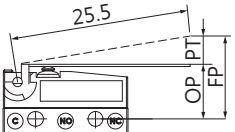
SWITCH TYPE	PART SUFFIX	OF Max. (gf)		OP (mm)	PT Max. (mm)	OT Min. (mm)	MD Max. (mm)	FP Max. (mm)	RF Min. (gf)	
		H	S						H	S
SW1- □□□□ -00 □□ -Z		H	355	8.4±0.3	1.2	0.6	0.2	9.9	H	100
		S	203						S	50
		L	150						L	30
		D	95						D	10
SW1- □□□□ -01 □□ -Z		H	121	8.8±1.1	4.3	0.9	0.6	12.0	H	22
		S	82						S	16
		L	73						L	14
		D	50						D	4
SW1- □□□□ -02 □□ -Z		H	105	8.8±1.2	4.8	1.0	0.7	12.4	H	20
		S	66						S	13
		L	55						L	11
		D	-						D	-
SW1- □□□□ -03 □□ -Z		H	72	8.8±1.6	6.3	1.6	0.9	13.5	H	17
		S	54						S	11
		L	29						L	6
		D	-						D	-